

610/620-Series

SMALL-SIZED ROCKER SWITCHES

The 610/620-Series switches are double insulated and available in single or double pole configurations. These snap-in mounted switches are offered with either a paddle or rocker actuator and with ratings up to 8 amps.

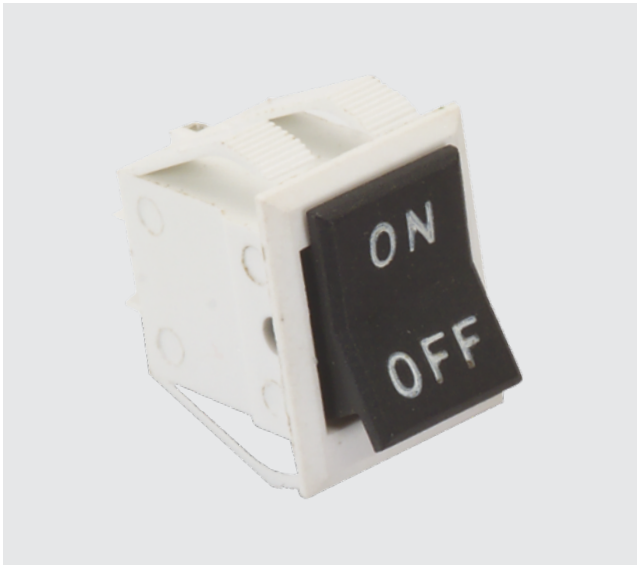

Product Highlights:

- Single or double pole
- Paddle rocker actuator options
- Snap-In mounting method

Typical Applications:

- Handheld Appliance
- Audio-Visual
- Power Supplies
- Computers



Carling Technologies®
Innovative Designs. Powerful Solutions.

Techna

www.techna.co.uk

Dielectric Strength

UL/CSA:
1000V - live to dead metal parts
& opposite polarity

Electrical Life

50,000 cycles- single pole
50,000 cycles- double pole

Operating Temperature

32°F to 185°F (0°C to 85°C)

62012421 - **0** - **0**

¹
Base Part Number

²
Terminal
Sealing

³
Legend

1 BASE PART NUMBER: SERIES / CIRCUITRY / RATING ¹ / TERMINATION ¹

4A 250VAC; 8A 125VAC
Single Pole

	Solder Lugs	PC Term
On-none-On	62011421	62011422
On-none-(On)	62011431	62011432
On-off-On	62011461	62011462
On-off-(On)	62011471	62011472
(On)-off-(On)	62011481	62011482
Double Pole		
On-none-On	62012421	62012422
On-none-(On)	62012431	62012432
On-off-On	62012461	62012462
On-off-(On)	62012471	62012472
(On)-off-(On)	62012481	62012482

2 TERMINAL SEALING

0 None
E Epoxy sealed terminals

3 LEGEND

NO LEGEND hot stamp
On-OFF vertical **0**
On-OFF horizontal **A**
I-O horizontal **B**
I-O vertical **D**
G

Notes:

¹ Base part number specifies black rocker and bezel. To specify paddle actuator, change 2nd digit of part number from 2 to 1 (ex. 61012421) For additional ratings and colors, consult factory.

() indicates momentary function.

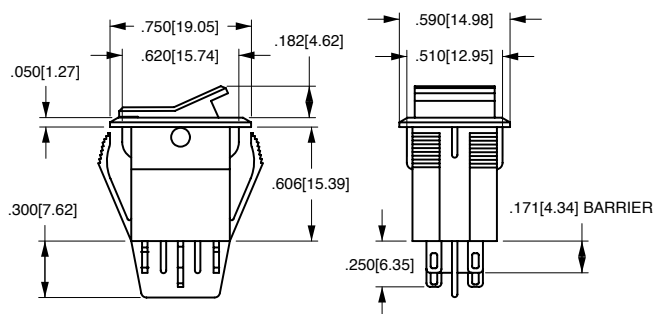

<p>.284[7.21] .078[1.98] .046[1.17] .029[.736]</p>	<p>.171[4.34] .250[6.35]</p>
PC TERMINAL	.080 SOLDER LUG
TERMINAL TYPE	

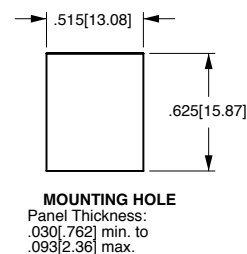
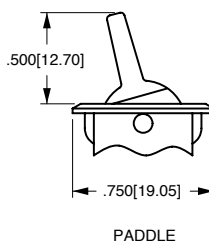

*Manufacturer reserves the right to change product specification without prior notice.